

SONY
make.believe

Web Intents Addendum - Local Services Live Demo

2012/7/11

kensaku.komatsu@ntt.com from NTT communications

naoyukiB.sato@jp.sony.com from Sony

CONFIDENTIAL 秘

Web Service



Web app

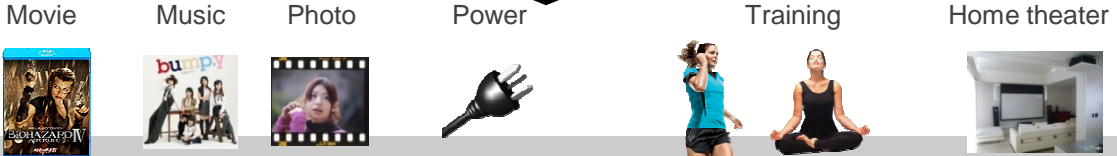

Web Home Browser



Home network API

Home Network Device



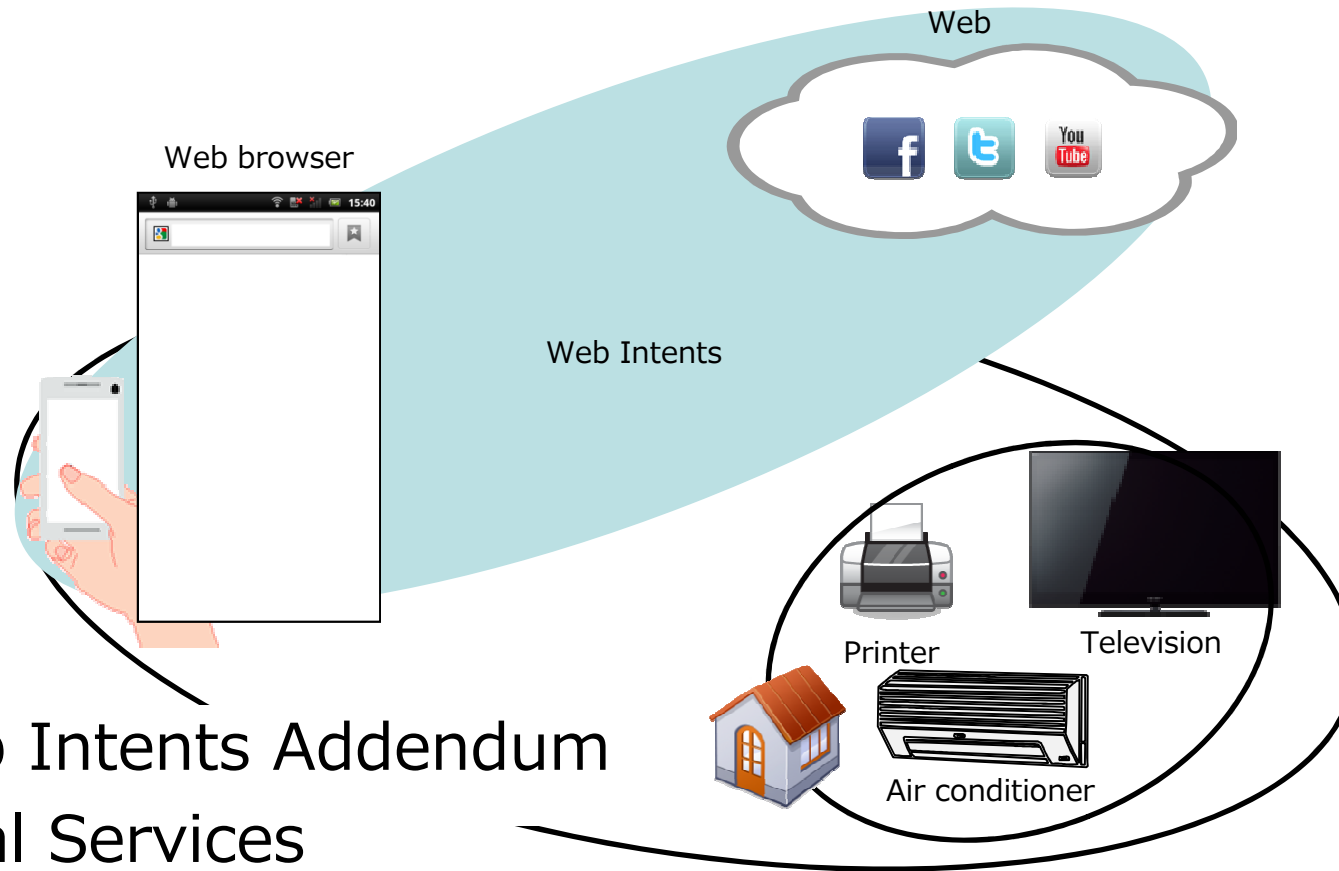

Web Intents Addendum Local Services

Local Service – Live Demo

- Use case
 - Push movie from Mobile to Rendering device and control
- Protocol
 - Follow SOMC Claes's spec as much as possible
 - <http://w3c-test.org/dap/wi-addendum-local-services/>

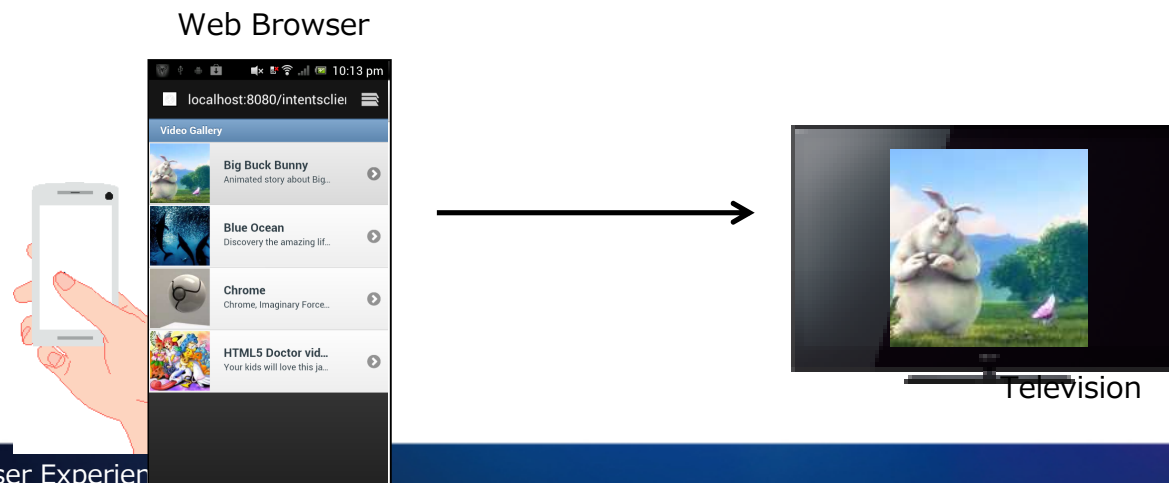

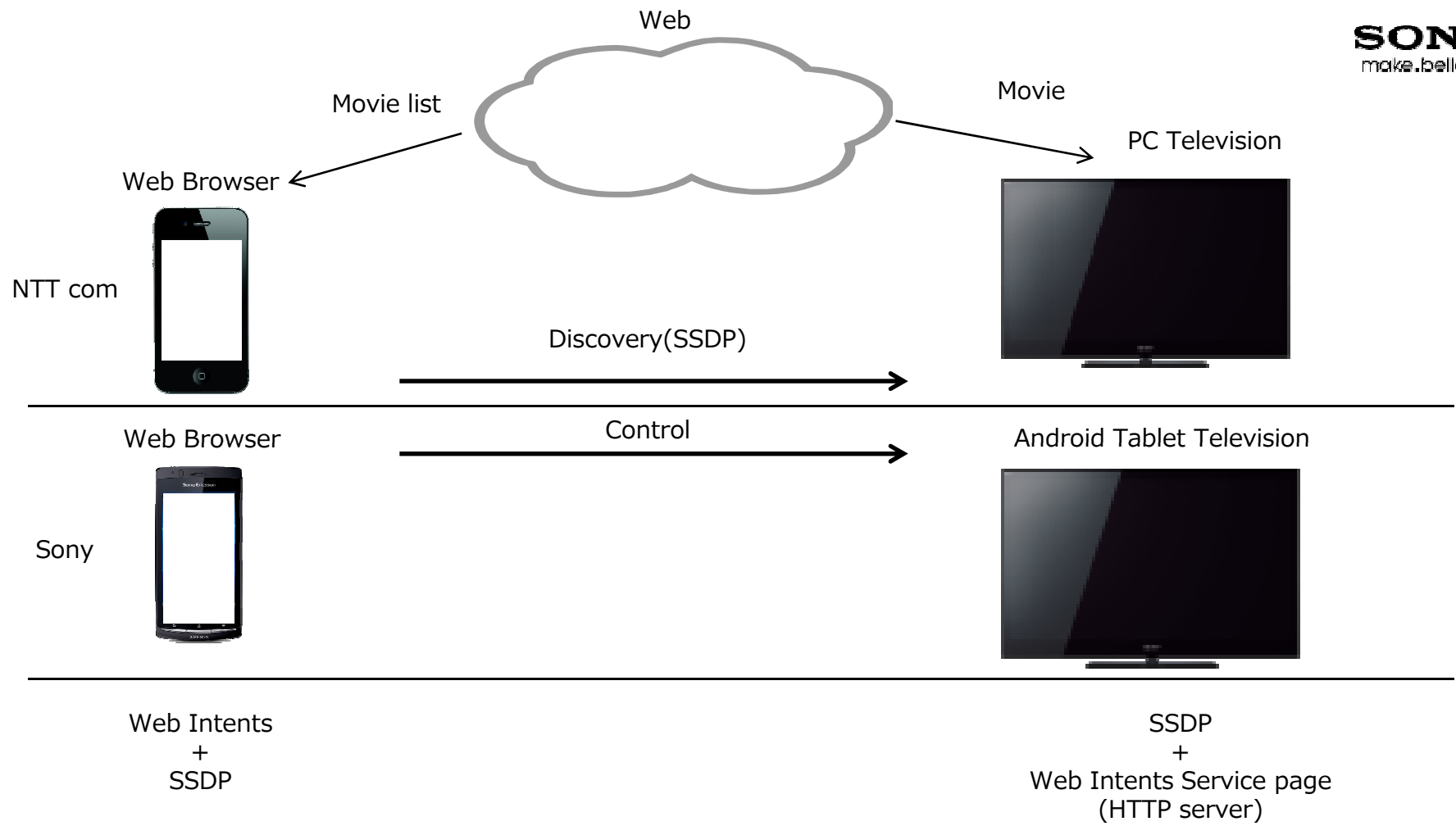

After invoke the service – UI page will be provided by Service.

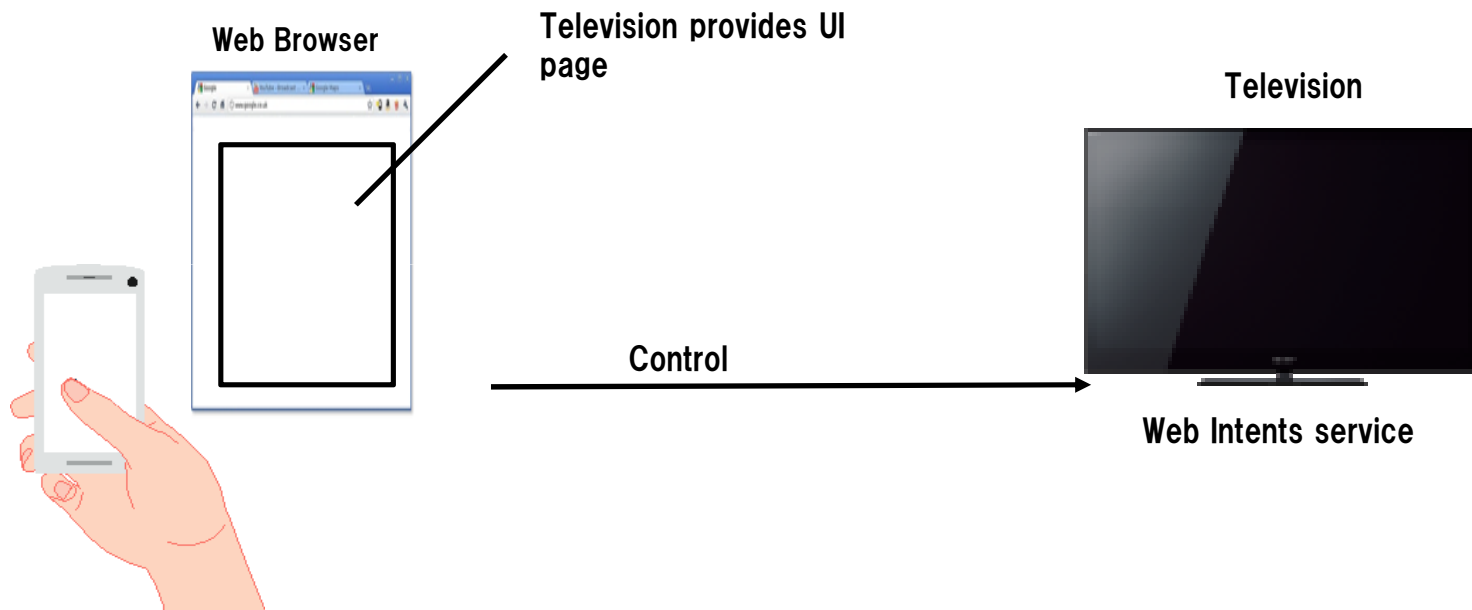

After invoke the service - hidden page will be provided by Service.

